

170WATT CHARGER INSTALLATION MANUAL

SAFETY INSTRUCTIONS

- The PSU must be reliably connected to earth.
- In accordance with IEC415 No.5017, a label showing the protective earth symbol should be placed adjacent to the installation earth.

INPUT VOLTAGE SELECTION AND FUSING

The PSU operates from two user configurable supply voltages 120/230Vac @ 50/60Hz, with a maximum tolerance range of 108-132Vac and 207-253Vac.

The PSU is configured by removing the cover (held in place by screws 'x').

The link is moved to the 230 or 120V connection as required.

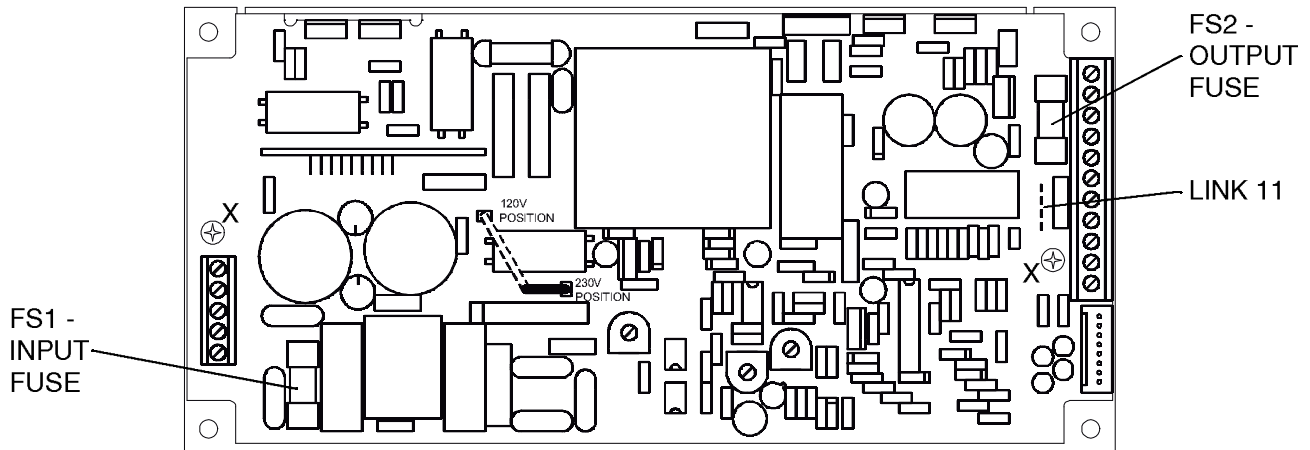

The input fuse is also accessed by removing the cover, as above.
The battery reverse connection fuse is accessible without removing the cover.
Both fuses must be replaced by fuses with the same type and rating.

OUTPUT VOLTAGES AND CURRENT RATING

12V UNIT

OUTPUT	VOLTAGE	CURRENT (MAX.)
1	14.375V	12A
2	13.65V	4A

24V UNIT

OUTPUT	VOLTAGE	CURRENT (MAX.)
1	28.75V	4A
2	27.3V	2A

The maximum power output from the PSU is 170W. Any combination of currents can be taken from each output (up to their respective maxima) provided that this be $\leq 170W$.

Do not operate the PSU above its maximum rated power.

The PSU is for use in a maximum ambient of 40 °C.

Output 2 is temperature compensated to provide a variable float voltage when charging sealed lead acid batteries.

The temperature is sensed by a thermistor incorporated into the PSU. If an external thermistor is to be used via the connections provided the internal thermistor must be disabled. This is done by removing the cover and cutting link 11.

FINAL MOUNTING PANEL

The Power Supply Unit can be mounted via its chassis in two positions.

- Vertically as in position 'A' with the corner of the Chassis facing downwards.
- Or flat to the mounting surface as in position 'B'.
- A DIN rail mounting kit is available as an optional extra.
(Vxl Power Part No. 14613-000)

