

## 130W CHARGER INSTALLATION SHEET

### SAFETY INSTRUCTIONS

- The PSU must be reliably connected to earth.
- In accordance with IEC415 No.5017, a label showing the protective earth symbol should be placed adjacent to the installation earth.

### INPUT VOLTAGE AND FUSING

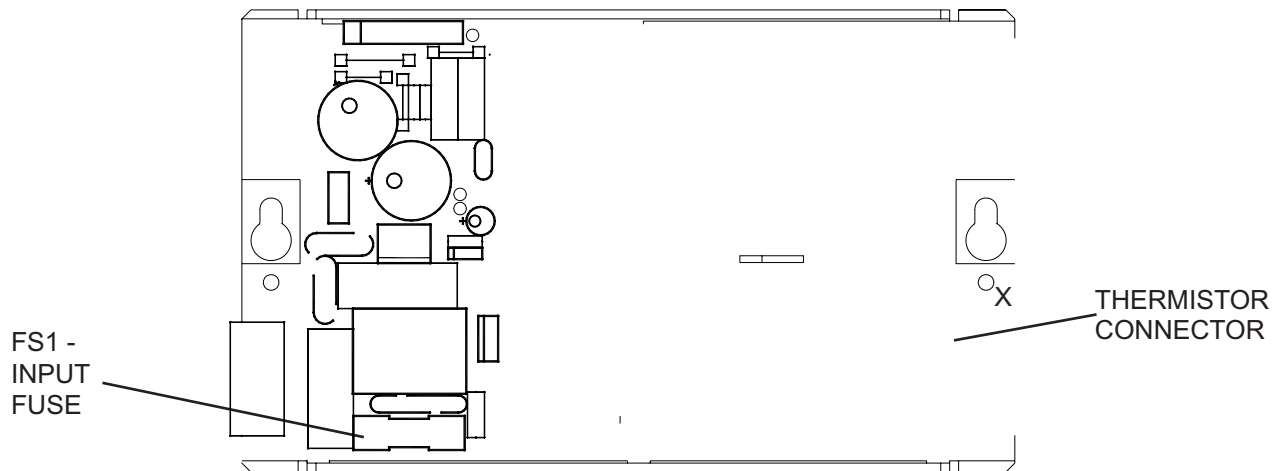

The input fuse is accessed by removing the cover (held in place by two screws 'X').  
The fuse must be replaced with the same type and rating.

### SITING THE THERMISTOR

The thermistor **MUST** be connected for correct operation. The thermistor is used to sense the battery temperature and should be placed within the vicinity of the system batteries.

### OUTPUT VOLTAGES AND CURRENT RATING

#### 24V UNIT

OUTPUT	VOLTAGE	CURRENT (MAX.)
1 MAIN	28.8V	4.5A
2 BATT	27.2V	3.0A

The continuous power output from the PSU is 130W. Any combination of currents can be taken from each output (up to their respective maxima) provided that this be  $\leq 130W$ .

The PSU is for use in a maximum ambient of 40 °C.

Output 2 is temperature compensated to provide a variable float voltage when charging sealed lead acid batteries.